



College of
Southern Idaho
Foundation

2024-2025 ANNUAL REPORT



60
YEARS
COLLEGE OF SOUTHERN IDAHO

Letter from the President



Dear Friends of the College of Southern Idaho,

This year, the College of Southern Idaho proudly celebrates its 60th year—our **Diamond Anniversary**. As we mark this milestone, I write to you with deep gratitude for your past, ongoing, and future support. I have renewed excitement for the path ahead as we build on sixty years of institutional excellence in the Magic Valley, and beyond.

Diamonds are known for their clarity, strength, brilliance, and enduring value—qualities that also define the College of Southern Idaho. For six decades, CSI has been a source of opportunity, resilience, and transformation across our region. Like a diamond forged under pressure and refined over time, CSI has emerged as an example of what community, commitment, and vision can achieve. The College of Southern Idaho and the Magic Valley have achieved remarkable success together—and we will continue to do so in the future.

Your generous support has been integral to our journey. Whether you have contributed to scholarships, academic programs, facilities, or student services, your investment has strengthened our Foundation and empowered thousands of students to discover their potential and shape their future. **For this, we thank you!**

As we look to the future, we remain focused on innovation and excellence. But we cannot do it alone. The challenges of tomorrow require the same bold generosity that has sustained us through the decades. Your continued support—your diamond legacy—will ensure that CSI remains a source of brilliance for generations to come.

Please consider reaffirming your commitment to CSI during this celebratory year. Every gift, no matter the size, plays a role in shaping lives and uplifting our community. On behalf of our students, faculty, and staff, thank you for being part of our enduring legacy. Together, we shine brighter.



With heartfelt gratitude,

Dr. L. Dean Fisher





Table of Contents

2	Letter from the President	14	Alumni Hall of Fame
4	Golden Eagle Statistics	20	Athletic Hall of Fame Inductees
5	Foundation Assets & Scholarship Distribution	22	Community Donors
6	Business & Organization Donors	24	Mini Grant Highlight
7	Faculty & Staff Excellence Awards	25	Make a Donation, Make a Difference
8	New Endowments, Scholarships & Funds	26	Metallica Scholars
9	Faculty & Staff Excellence Awards	28	LeRoy Craig Jerome Center
10	Golden Eagle Athletics	29	Delta Dental of Idaho Grant
		30	Gilbert's Interview Closet
		31	Foundation President Letter

We Are The Golden Eagles!

Facts At A Glance - Source: CSI Internal Reporting FY 2024-2025
 These numbers do not include dual credit students.

Head Count

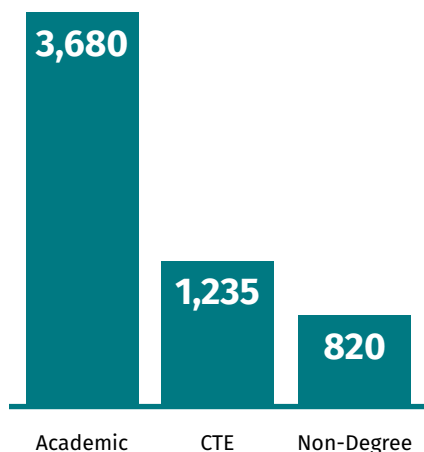

Source: CSI's 2025 Idaho State PSR report

Off-Campus Centers



Top Programs

Based on Summer 2023-24, Fall 2024-25, Spring 2024-25 Conferred Degrees, courtesy of Internal Research.

Academic 2025

- 1 Liberal Arts
- 2 Nursing
- 3 Health Science
- 4 Education
- 5 Business Administration
- 6 Criminal Justice
- 7 Operations Management
- 8 Psychology
- 9 Animal Science
- 10 Agribusiness

CTE 2025

- 1 Nursing
- 2 Veterinary Technology
- 3 Welding Technology
- 4 Radiologic Technology
- 5 Education
- 6 Accounting/Bookkeeping
- 7 Business Management/Entrepreneurship
- 8 Geospatial Technology
- 9 Dental Hygiene
- 10 Introduction to Cyber Security

Student Profile

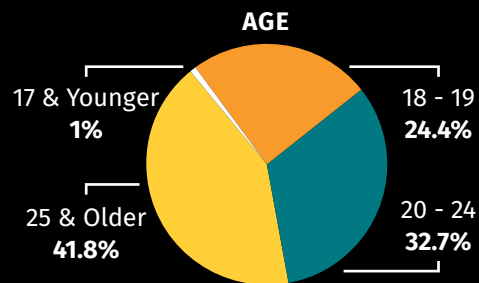

RESIDENCY



ENROLLMENT

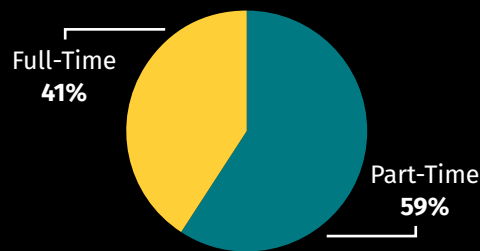

GENDER

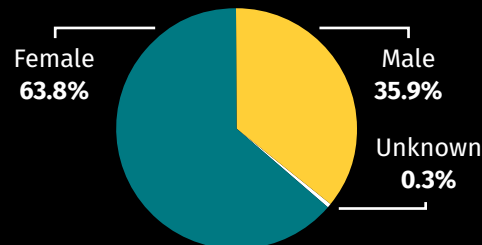

Based on degree-seeking students
 Source: CSI's 2025 Idaho State PSR report



Over
\$3.5 Million
 awarded in scholarships
 and distributions

CSI Foundation Assets

Asset management is an important function of the Foundation. It includes oversight of investments and a balancing of long-term strategies. Optimizing the annual disbursement of scholarship dollars while enhancing the value of core resources is critical.

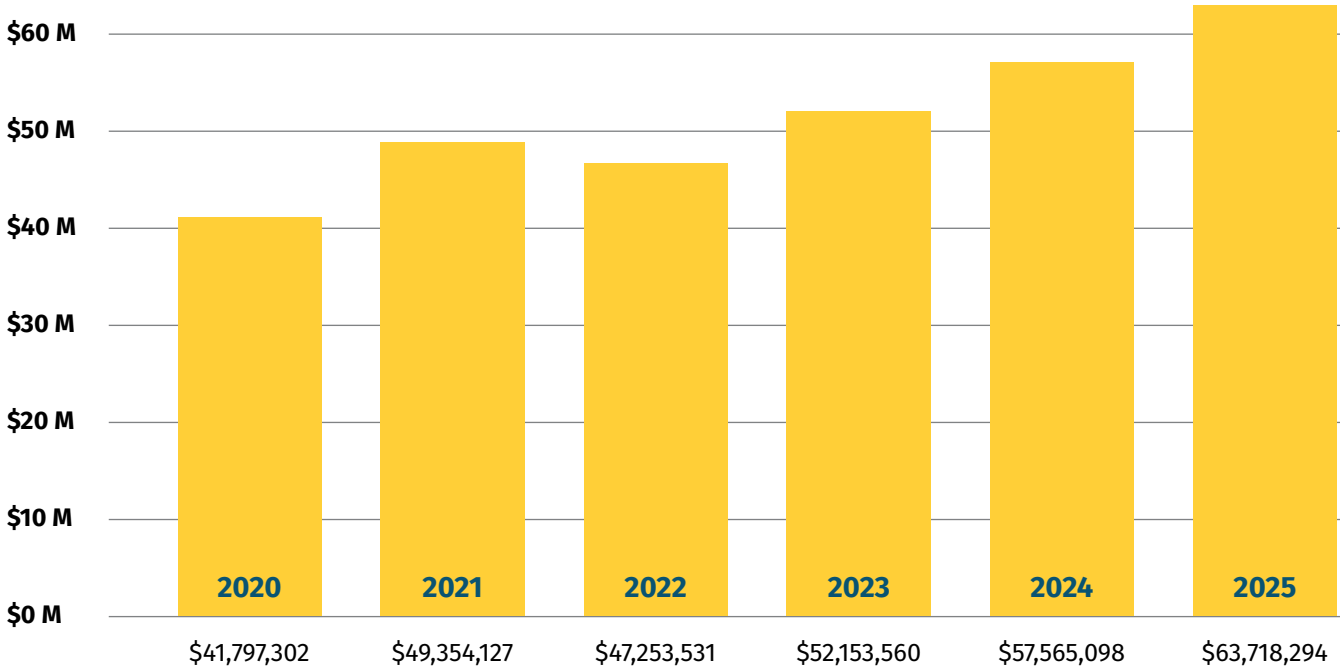

Scholarships & Distributions

Total amount of scholarships and grants awarded in the past five years.

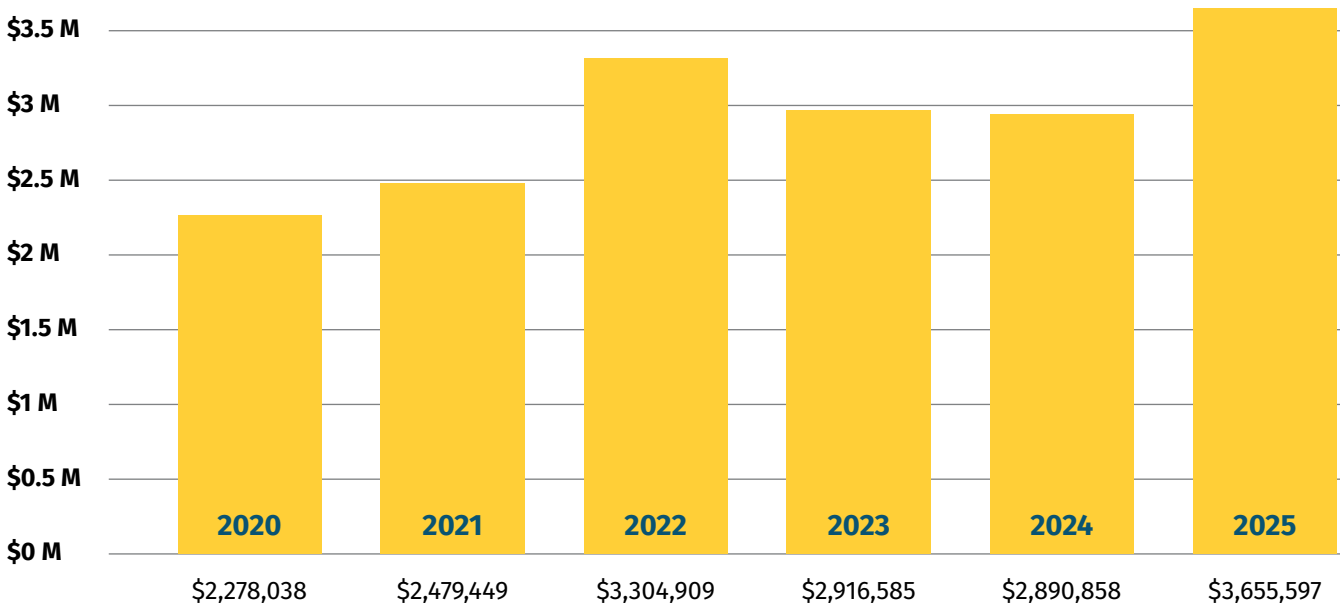

Business & Organization Donors

Your donations make a significant difference to CSI Students. When you donate, you are not only supporting our students financially but also changing the future for the students and their entire families. The generous donations acknowledged in this report were made between July 1, 2024 and June 30, 2025. Thank you for making the choice to help our Eagles soar!

4B Livestock	Chapter AP PEO	Gail Richardson Memorial Charitable Fund	Idaho Grain Producers Association
5 Cents Livestock	Chapter E PEO Sisterhood	Gary D. Slette, P.A.	Idaho High School Rodeo District 2
Adams Excavating Inc	Charz Idahome LLC	General Water Technology Inc	Idaho Humanities Council
Agri Beef Management	Cherokee Nation	Glanbia Business Services	Idaho Irrigation Equipment Association, Inc.
Albert M. Lowry High School	Citizen Potawatomi Nation	Glenns Ferry School Dist 192	Idaho Joe's
Albion Telephone Co	City of Blackfoot	Golden Eagle Booster's Inc	Idaho Milk Products
Alzheimer's Association	City of Star	Gooding County	Idaho Snow & Trail Riders
Amalgamated Sugar Co	Clark Fork High School	Gordon Thrift Shop	Idaho State Grange
American Association of Psychiatric Technicians	Clark Rodeo Ranches LLC	Grace Community Church	Idaho Virtual Academy
American Falls School District No. 381	Community Assistance League	Grassroots Cutting Horse Association, Inc.	IDES
American Indian Services	Con Paulos Chevrolet	Great Basin Elks Lodge #1472	Immaculate Conception Church
American Legion Auxiliary	Consolidated Supply Co	Greater Pocatello Association of Realtors Inc	Imperial Sovereign Gem Court of Idaho
American Legion Post No 7	Constellation Power	Hagerman Alumni Association	Innovation Medical Imaging
B & H Office Shops	Cowboy Concrete LLC	Hamer Lions Club	Innovative Concrete LLC
B&B Electric, Inc.	D&B Supply	Hanssen Cattle LLC	International Assoc of Lions Clubs
Backyard Bronc Bash	D.L. Evans Bank	Hanssen Construction LLC	International Pipe Irrigation Association
Basin No. 72 School District	Deleon Homes of Idaho LLC	Hardway Pipeline LLC	ISTS Inc
Berkshire Hathaway	Delta Dental of Idaho	Hatfield Manufacturing Inc	J. Evan Robertson, P.A.
Bish's RV Inc	Diamond H Trailer Sales	Henry Schein Inc	Jae's Place
Bison Pipe & Supply LLC	Dietrich School District 314	High Mountain Metal LLC	James Ray Inc.
Black Pine Cabinets	Dilettante Group of Magic Valley	Horatio Alger Assoc. of Dist. Americans	Jeffrey E. Rolig, P.C.
Blaine County School District	Dutch Touch LLC	Hospice Visions	Jerome Civic Club
Bliss Student Body	Eagle Rock Lodge No. 19	HUB International Insurance	Jerome High School
Blue Lakes Automotive Inc	Ed Muegerl Education Trust	Humboldt County Cattlewomen	Jerome Rural Fire Dist #1
Blue Lakes Chiropractic. P.A.	Edward Ramsdale Scholarship Fund	Humboldt General Hospital Employee Fund	John L Muegerl Charitable Trust Account
Boesiger's Repair LLC	Elite Restoration	Hwy 30 Music Fest	Joint School District No, 261
Bogus Diesel Repair & Welding, LLC	Elko County School District	IAHD Scholarship Fund	JW N Sons Inc
Boundary County School Dist #101	Ewell Educational Services Inc	Idaho AEYC	K&T Steel Corporation
Box Elder Chamber of Commerce	Excel Backflow Service Inc	Idaho Association of Counties	Kalispell Youth Softball Assoc
BPO Does Drove #190	Extreme Electric Inc	Idaho CapEd Credit Union	Kidd Performance
BPOE Lodge #2276	Fallon Pauite-Shoshone Tribe	Idaho Caregiver Alliance	King Rodeo Company
Buhl Chamber of Economic Development & Commerce Inc	Far + Wise	Idaho Central Credit Union Headquarters	Kiwanis Club of Burley
Burley High School	Farmers Bank	Idaho City High School	Kiwanis Club of Rupert
C.M. Fiala, Inc	Farmers Grain Cooperative	Idaho Dig Co, LLC	Kiwanis Club of Shelley
Cable One, Inc	Fernley Lodge 34 F & AM	Idaho Farm Bureau Federation	Kiwanis Club of Twin Falls
Caldwell School District No. 132	Fiber Care Baths, Inc	Idaho Garage Door	Knights of Columbus No 3703
Castleford Com Mens Club Inc.	Filer High School		La Fiesta Mexican Restaurant
Challis Joint School District #181	First Federal Savings Bank		Lauterbach Educational Trust
Chapter AI PEO	Frank Henry and Lois Elizabeth Rohay Trust		
	Franklin Co Distinguished Young Women		

Business & Organization Donors

Lee W. Schmidt Scholarship Tr Fund
Les Schwab Warehouse Center, Inc
Lithia Chrysler Jeep Dodge of
Twin Falls
Lytle Signs, Inc
Magic Valley Arts Council
Magic Valley Builders Association
Magic Valley Cattle Assoc
Magic Valley Chorale
Magic Valley Electric
Magic Valley Energy LLC
Magic Valley Stampede Gold
Buckle Club, Inc.
Magic Valley Symphony
Orchestra, Inc.
Malheur County School
District No 84
Marigold Mining Co
Marsing Lions Club Inc
MartinWren PC
McCall-Donnelly FFA Alumni &
Supporters
Melva Rebekah Lodge 105
Meridian Lions Club
MICA Flats Grance No 436
Middlekauff Auto Group
Minidoka Memorial Hospital Guild
Modern Woodman
Moore, VanEngelen, Pollow, CPAs
Moscow Bear Boosters
Mountain Pacific Investment
Advisors
Mrs. Sue's Scholarship Fund
Mt. Wheeler Power Company
Muckleshoot Indian Tribe
Mud Lake Telephone
Murtaugh School District 418 -
Assoc of Students
Nannini, Inc
New Plymouth High School
NIRA Rocky Mtn Region
North Canyon Medical Center
North Lyon County Fire Protection
District
Northwest Services Inc
Nucor Steel Utah
Oasis Stop N'Go LLC
On Your Mark
Oregon Human Development Corp
Owyhee Conservation District
Paul and Roberta Jacobsen Trust
PEO Chapter I
Performance Plus - Idaho LLC
Peterson's Reliable Electric
Petterson Dairy, LLC
Pinehurst Quilt Club
Portneuf Range Pyrenees
Prairie City Fiber Fest
Prescott & Craig Inc
Prescott Ranch
Preservation Twin Falls, Inc.
Quality Inn & Suites
Queen Esther Chapter #12
R&R Truck & Auto Repair
Racing for Charity
RLB Architectura
Rob Green Buick, GMC
Rogue Credit Union
Roman Catholic Diocese of Boise
Rotary Club of Teton Valley
Rotary Club of Twin Falls
Rotary Club of Upper Kittitas Co
Rural Telephone Co
Salmon River Propane Inc
Sandpoint Elks Lodge BPOE #1376
Sandpoint High School
Sankey Pro Rodeo
Sawtooth Rangers, Inc
Scholarship America
Scholes Dermatology
Select Health
Shoshone-Bannock Tribes
Shoshone-Paiute Tribe of the Duck
Valley Reservation
Silvies Valley Ranch LLC
SkillsUSA
SMART Scholarship Funding Corp
Snake River RV & Hitch, Inc.
Soda Springs Lions Club
Spanish Fork High School
St. John's Lutheran Church
St. Luke's Corporate Office
St. Charles Borromeo Catholic
Church
St. Elizabeth's Catholic Women
Standlee Premium Products LLC
Starley-Leavitt Insurance Agency,
Inc.
Stephan, Kvanvig, Stone & Trainor
Swire Coca-Cola
Tanis Construction LLC
The Andersons Inc
The Navajo Nation
The Senior Connection
The Shoe & Tack Shop
Thornton Heating & Sheetmetal
Thrivent Financial
TitleFact, Inc.
TitleOne
Tommy's Express
Tony's 2T Auto Inc
Tri-County Junior Livestock
Trinity Health
Trinity United Methodist Church
True West Beef LLC
TruLeap Technologies
Twin Falls Chevrolet
Twin Falls County
Twin Falls Hawks American Legion
Baseball
Twin Falls Health Initiative Trust
Twin Falls School District No. 411
Twin Falls Subaru
Utah Youth Soccer Assoc
Valley Adams County Farm Bureau
Valley Building LLC
Valley View Veterinary Clinic
Valley Wide Cooperative Inc.
Vigilante Electric Cooperative Inc
Virgin Valley High School #944
Volunteers of America of Oregon
Inc
Wayne Stewart Scholarship Trust
Wendell Chamber of Commerce
Wendell High School
West End Men's Association
West Jefferson High School
West Side High School
Western Bean Dealers Assoc
Western Treasure Valley Rotary
Club
Westmount Partners LLC
Whitepine Lions Club
Whitesides Dairy, Inc.
Wills Toyota
Winnemucca FFA Alumni Assoc
Winnemucca Volunteer Fire Dept
Wood River High School PTSA -
Senior Bash
Woodgrain Millwork, Inc,
Wright Brothers Law Office PLLC
Wright Physical Therapy

New Endowments, Scholarships, & Funds

Established between July 1, 2024-June 30, 2025.

Auto Ranch Foundation Inc Scholarship
Bonnie K Smazal Capital Projects
Bonnie K Smazal Scholarship Endowment
Caldwell Foundation for Educational
Opportunity Scholarship
Cassia County Education Foundation
Inc Scholarship
CSI Men's Soccer Team
CSI Women's Soccer Team

Don Royster Memorial Foundation
Ed Foundation of Blaine County School
District Scholarship
Far + Wise Scholarship
Idaho Foundation FFA Scholarship
Idaho Irrigation Equipment Association
Scholarship
Idaho Small Business Development Center
In-demand Careers

Kurt & Genola Kandler Scholarship
North Canyon Medical Center Scholarship
On Your Mark Scholarship
Paul Jacobsen Family Endowment
Scholarship America Scholarship
Select Health Scholarship
Shoshone-Paiute Tribe Scholarship
TechForce Foundation Scholarship

Honorarium Gifts

Looking to celebrate a special occasion with someone who already has everything? Honor them by making a donation to the CSI Foundation in their name. CSI students have benefitted through honorarium gifts given for the following people between July 1, 2024-June 30, 2025.

Maxine Bell

Joyce Craig

Megan Laughlin

Memorial Gifts

The College of Southern Idaho Foundation, Inc. received donations in memory of the following people between July 1, 2024-June 30, 2025. We are extremely grateful to the friends and family members who chose to remember the students at CSI during very difficult times.

Albert Anderson
Wilma Anderson
John M & Rose S Barker
Courtney Bingham
Nedra Bunker
Margaret Burks

Kamala Campbell
Jerry Carlile
Bradford Craig
Chance Craig
LeRoy Craig
Neil Cross

Frank Hirai
Jim Hoggatt
Terry Hollifield
Dave Horalek
Gerald "Huck" Hulsey
Grant Karel

Gabe Kleinfopf
Gene Loranger
Pauline Meyerhoeffer
Sally Nelson
Walter F Peterson
Rexine Waldron Rowley

David Skiver
Marvin Strobe
Joan Sullivan
Mike Tremblay
Scott Turner
Donald Wolverton

Faculty & Staff Excellence Awards

Congratulations to this year's CSI Outstanding Faculty and Employees of the Year!

Help the CSI Foundation endow this project. By creating an endowment, you have the opportunity to make a lasting impact on our faculty and staff, ensuring that excellence is recognized and rewarded for generations to come. Your support will institutionalize these awards, fostering a culture of innovation and dedication that will elevate our entire community. Contact the CSI Foundation to learn more about CSI's faculty and staff excellence awards.



Ginger Narum

Professional Employee
CCR/GED Test Coordinator
College and Career Readiness



Teresa O'Dell

Classified Employee
Account Technician
Business Office



Burcu Seyben

Academic Faculty
Associate Professor
Theatre and General Education



Robyn Swainston

Career & Technical Faculty
Professor
Automotive Tech



Golden Eagle Athletics

Written by: Karen Baumert, CSI Sports Information Director

It was another successful year for CSI Athletics. Every sports team finished the 2024-25 school year with a 3.0 GPA or above. At the NJCAA level, several CSI Athletic Teams shined. The CSI Women's Cross Country Team placed fourth in the nation, the CSI Women's Basketball Team won a Scenic West Athletic Conference Championship, the CSI Softball Team claimed a Scenic West Athletic Conference Title, a Region 18 Title and qualified for its fourth straight national tournament, and the CSI Cheer Squad placed third at NJCAA Cheer Nationals.

CSI Cross Country/Distance Track

The Golden Eagle Women's Cross Country Team placed fourth and the men 13th at the NJCAA Division I Cross Country National Championships. CSI's Rozlyn Cazier brought home All-American honors with a 15th-place finish. The Golden Eagles continued their success through indoor and outdoor track, finishing with four indoor All-Americans and six outdoor All-Americans.

The Men's Team posted a 3.34 GPA for the year and had five individuals earn academic honors. The Women's Team finished with a 3.41 GPA and eight individuals earning academic honors. Three runners are moving on to run at the next level.





CSI Rodeo

CSI Rodeo qualified four individuals for the College National Finals Rodeo. Ashton Zabriskie, Coy Montgomery, Dahl Winters and Hailey Gibbs all competed. Winters was the Rocky Mountain Region Bareback Riding Champion; Montgomery was the runner up. Zabriskie won the Bull Riding region title and Gibbs was the Rocky Mountain Region All-Around Cowgirl Champion.

CSI Women's Basketball

The Golden Eagles won the Scenic West Athletic Conference regular season title, finishing with a 23-8 overall record. Head Coach Randy Rogers was selected Region 18 Coach of the Year for the 10th time in his career. Three players were selected all Region 18 and Kennedy Gillette was named NJCAA All American. In the classroom, CSI posted a 3.53 GPA and had six individuals recognized as well. Four players will be moving on to the next level.

CSI Softball

CSI Softball won the Scenic West Athletic Conference Title, the Region 18 Title and qualified for its fourth straight NJCAA National Tournament. The Golden Eagles also excelled in the classroom, posting the department's highest GPA with a 3.59. Ten players were also honored for finishing with a 3.6 or higher GPA. Nick Baumert reached his 800th win during the season as was named Region 18 Coach of the Year for the eighth time in his career. The Golden Eagles placed seven players on the All-Region 18 Team and four were selected to the Region 18 All-Tournament Team. Eva Stoddard was named tournament MVP.



*Donate to CSI
Athletics
Department*





CSI Men's Basketball

The Golden Eagles finished the season with a 22-10 overall record and a second-place finish at the Region 18 Tournament.

Three players were selected to the All-Region 18 Team and seven are moving on to the four-year level. In the classroom, CSI finished with a 3.38 GPA and had five individuals honored for a GPA of 3.6 or higher by the NJCAA.

CSI Baseball

CSI Baseball had an amazing 16 players earned NJCAA Academic All-American honors in the classroom along with a team GPA of 3.43. The Golden Eagles signed eight players to the next level including Jack Barker who was drafted by the Phillies in the 13th round.

Four players were selected to the All-Region 18 Team.

CSI Cheer

For the first time ever, CSI competed in cheer at the NJCAA level. The Golden Eagles represented the college well, taking third place in all-girls division. CSI followed that up, competing at USA Nationals, placing second in Sideline, third in Stunt Group and second in Show. The Golden Eagles also were recognized in the classroom, posting a 3.42 GPA with three individual Academic All Americans.



CSI Dance

The Golden Eagles claimed their second national championship in dance at USA Nationals. CSI won the Pom Division and finished as the runner-up in Jazz. In the classroom, the Dance Team combined for a 3.15 GPA.



CSI Women's Soccer

Competing in their first season ever, the Golden Eagles had a great year on the field and in the classroom. CSI finished with a record of 5-8-3 in competition and posted a 3.41 team GPA. Individually, seven players also finished with a GPA above a 3.60 for NJCAA national honors.

CSI Men's Soccer

CSI Men's Soccer played its inaugural season in the 2024-25 school year, finishing with a 6-9-1 record. Academically, the Golden Eagles finished with a 3.09 GPA and had two individuals recognized with NJCAA honors, posting a GPA over 3.60.



Alumni Hall of Fame

The inaugural Alumni Hall of Fame Awards, held this past April, honored individuals who reflect the very best of what CSI stands for. Through their professional achievements, community leadership, trailblazing spirit, and athletic excellence, they represent the legacy we've built together-and the future we're creating.



For her exceptional achievements in her career, we honor

Amy Bradley

Class of 2001

with the Professional Accomplishments Award.

Amy Bradley is a proud graduate of the CSI Registered Nursing Program who has established a distinguished career in her role with the St. Luke's Health System. Amy currently serves as the Chief Nursing Officer/Chief Operating Officer of St. Luke's Magic Valley.

She has worked her entire career serving this community as a nurse for St. Luke's Health System. She started as a new graduate on a medical floor, soon became a Charge RN on that floor, and advanced to Nursing Administrative Supervisor over the entire facility within two years. Twelve years later she assumed a manager role over the hospital's float pool and seven years later she was promoted to a Nursing Director role that oversaw all inpatient medical/surgical beds, ICU, Dialysis, Respiratory Therapy, and Cardiac Monitoring.

Currently as Chief Operating Officer/Chief Nursing Officer for St. Luke's Magic Valley, Amy is the point leader for the entire 224-bed facility. At present, 2,500 employees directly or indirectly report to her including the main campus, the outpatient surgery center, and the offsite inpatient behavioral health facility (Canyon View).

Since obtaining her degree from CSI, Amy completed her Bachelor of Science in Nursing and her Masters of Science in Nursing Leadership and Management degrees from Western Governor's University. She is a Registered Professional Nurse, a Board-Certified ANCC Nurse Executive, and an active member in two professional nursing associations (American Nurses Association and Nurse Leaders of Idaho). Her recent awards include St. Luke's Nursing Excellence Award and the coveted Caring Hearts (President) Award for Excellence in Leadership. She is formally trained in mass casualty incidents and donates often to community programs such as the local women's shelter, animal shelter, and clothing closets.

Amy's nominator shared, "I cannot imagine someone doing more with a 2-year nursing degree than Amy has accomplished in the past two decades. But seeing she plans to work for another 10-15 years; I am sure she will soon show us."

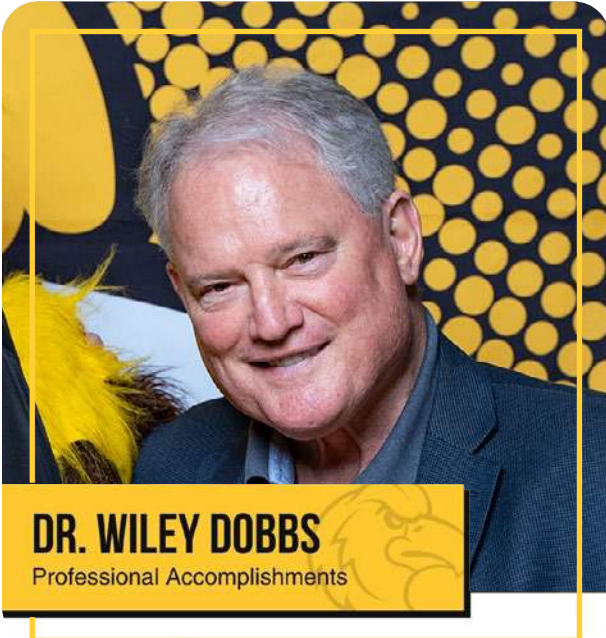

For his transformative work in education and administration, we honor

Dr. Wiley Dobbs

Class of 1978

with the Professional Accomplishments Award.

Wiley began his journey at the College of Southern Idaho, where he received his degree from Dr. James Taylor. As a standout athlete, Wiley competed on the CSI Judo Team and earned national recognition. His success at CSI earned him an athletic scholarship to San Jose State University, where he competed on the 1979 NCAA National Championship Judo Team. In 1980, he was invited to train at the U.S. Olympic Training Center in Colorado Springs, a prestigious honor reflecting his elite-level skill in the sport. Wiley continued his lifelong passion for judo, achieving a 5th-degree black belt from the Kodokan in Tokyo, Japan.

Wiley's academic pursuits led him to BSU, where he double majored in Social Science and Kinesiology. He later earned a Master's Degree from the College of Idaho and culminated in his formal education with a Ph.D. from the University of Idaho.

Throughout his career, Wiley served in multiple educational leadership roles. He impacted hundreds of students and athletes during his time at Bear Lake High School, O'Leary Junior High, and Twin Falls High School—coaching wrestling, volleyball, and track while teaching subjects ranging from American government to English. Wiley's leadership extended into administration, serving as Principal of Magic Valley Alternative High School and O'Leary Junior High. He was named Idaho Principal of the Year in 1998–99.

Wiley served as Director of Operations for the Twin Falls School District before becoming Superintendent in 2003—a role he held with distinction until 2017. Under his leadership, the district saw significant growth and innovation, and he was honored as Idaho Superintendent of the Year in 2013. Even after retiring from full-time administration, Wiley continues to influence education in Idaho and beyond through Wiley Dobbs Consulting, mentoring superintendents, principals, and school board members.



Judy's spirit of giving and tireless community involvement truly reflect the heart of CSI.

Judy Woody

Class of 1991

is the recipient of the Community Service Award.

While at CSI, Judy was an active member and student leader of the Postsecondary Agriculture Students organization. Judy, along with her husband Brent, have a long history of community service- particularly in agricultural education. Judy has been a long-time member of the Idaho Farm Bureau Federation and the Twin Falls County Farm Bureau. Judy was particularly active on the Farm Bureau Women's Leadership Committee where she facilitated youth educational activities to teach the community about agricultural production and farm safety along with speech contests, coloring contests, and fundraisers to benefit a variety of causes. Judy served as the State Chair for the Idaho Farm Bureau Women's Leadership Committee for several years before the Idaho Farm Bureau ended the Women's Leadership Committee and started a Promotion and Education Committee.

Judy coordinated the delivery of Idaho agriculture themed snack bags to Idaho senators and representatives to promote agriculture. She also coordinated annual fundraisers to benefit the Ronald McDonald House in Boise during Food Check Out week. Over the years, Judy has also served on many boards and committees all with the focus of impacting youth and agriculture education including the Idaho FFA Foundation Board, Idaho FFA Alumni Association, Idaho FFA State Convention Host Committee, Safe Kids Coalition, Idaho Ag in the Classroom Association Board, Idaho Women in Ag Committee, and the Agribusiness Committee for the Twin Falls Chamber of Commerce.

Judy is passionate about communicating the connection between farm production and groceries serving as a spokesperson for the industry during her work. She has volunteered at countless youth education days around the Magic Valley including Farm Safety Camps at the Twin Falls County Fairgrounds, 3rd Grade Idaho History Days at Stricker Station, and events held at local elementary schools. Judy has also served as the coordinator and superintendent of the Twin Falls County Farm Bureau Ag Pavillion at the Twin Falls County Fair for the last decade. She connects with agriculture industry organizations to facilitate educational activities for kids and adults visiting the Fair each year. She has been instrumental in bringing an agricultural mechanics student competition to the Fair.

Most recently, Judy served on the Promotion and Education committee for the Twin Falls County Farm Bureau. Judy is a constant supporter of the College of Southern Idaho and is proud to be an alumnus of our institution. Even after graduating more than 40 years ago, she and her husband Brent continuously seek to sponsor programs and engage with students.



Maria Alvarez Zavala, Class of 2017—is a shining example of CSI excellence in action is a Ph.D candidate in Plant and Environmental Science at New Mexico State University. Maria completed degrees in Chemistry, Geology, and Physics at CSI. Maria transferred to Westminster University in 2019 where she became a McNair Scholar and earned her B.S. in Chemistry. Later she transitioned to New Mexico State University where she earned her M.S. in Horticulture (minor in Applied Statistics in 2021) and is now working towards a Ph.D, her research is focused on Understanding Photosynthetic Systems Through Widely Accessible Microgravity Simulators.

Through this time, Maria has also earned numerous awards having become a recipient of a prestigious NSF GRFP fellowship and receiving the highest honors New Mexico State University offers for master's students at the college and university level. Moreover, Maria has earned fully paid professional development opportunities from industry (Bayer) and multiple professional organizations including the Society for Advancement of Chicanos/Hispanics & Native Americans in Science, and Annual Biomedical Research Conference for Minoritized Scientists. More recently, she was a NIH-RISE Post doctorate Scholar and a two-time recipient of the Southwest Airlines HACU Take Off Travel Award. Maria has also received the New Mexico NASA's Space Grant Consortium's Graduate Fellowship twice to conduct human/space simulation research and just became a co-PI in a federally and internationally funded grant for student academic and cultural exchange between New Mexico State University and Universidad de La Salle-Colombia. Additionally, Maria enjoys volunteering in mentoring programs and community organizations in the border region.



Maria Alvarez Zavala

Class of 2017

is the recipient of the Rising Star Award.







Lindsey Anderson

Athletics Hall of Fame

Lindsey, was hired to resurrect the CSI Cross Country and Distance Track Program in 2017, and created nationally recognized teams from the start. In her first season, she led the women's team to a fourth-place finish at the NJCAA Division I Cross Country National Championships and the men to a sixth-place finish. The Golden Eagles also had the Men's Individual National Champion that year. In 2020, she led the men's team to a national runner-up finish and the women's team to a third-place finish. Anderson coached for five years at CSI, reaching the peak of coaching accomplishments with a NJCAA Division I Cross Country National Championship in 2021 on the women's side. She also was named the NJCAA Coach of the Year. Her legacy lived on the next year as the Golden Eagles, with four of the same runners, won a second straight national championship.



Not only was she an accomplished coach, but she also was a talented runner. She started her running career at Weber State University, competing for the Wildcats from 2003 to 2007. She ended her collegiate career as a two-time All American in the 3000m Steeplechase and Indoor 5000m, and a school record holder in the 3000m Steeplechase, 10,000m, and Indoor 5000m. She went on to compete for the United States at the 2008 Olympic Games in Beijing, China, in the 3000m Steeplechase. She continued her training while coaching at College of Southern Idaho and later qualified for the Olympic Trials in the Marathon for the 2012 Olympic Games. From CSI, Anderson took her talents to University of Missouri, where she was the head Cross Country Coach for one year. After that, she made the move back to Weber State University to coach. Lindsey is an extraordinary coach whose talent, determination, and leadership have inspired countless others.

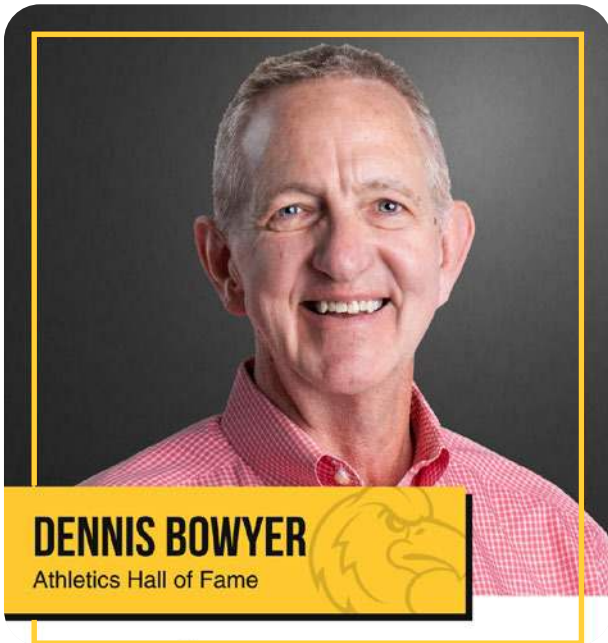

Dennis Bowyer

Athletics Hall of Fame

Dennis has contributed immeasurably to our campus and community, through decades of service and support. His dedication to students and athletics alike makes him an ideal inductee into the Athletic Hall of Fame.

Dennis, a Twin Falls Community icon, was a member of the 1976 College of Southern Idaho Men’s Basketball NJCAA National Championship team. During his two years at CSI, he helped the Golden Eagles to a 34-1 record in 1975-76 and a 32-2 record in 1976-77. Bowyer was a part of the two teams that set a national win streak of 49 games. In 1976, he played on the Junior Pan American Basketball Team that won a silver and gold medal in Brazil. After CSI, Bowyer finished his basketball playing career at Whitworth University in Spokane, Wash.



Bowyer has also made his mark in the Magic Valley. He was the City of Twin Falls Recreation Supervisor, then promoted to Director of Parks & Recreation for the City of Twin Falls where he stayed until retirement in June of 2015. He oversaw the development and management of parks, recreation activities, canyon rim trails, municipal golf course, municipal swimming pool and all other activities and development pertaining to parks and recreation for the City of Twin Falls.

Bowyer has been a longtime member of the Twin Falls Optimist Club and served as President. A member of the Idaho Recreation and Parks Association, he received the Dr. Leon Green Fellowship Award. Bowyer was a Boys and Girls Club of Magic Valley Board Member and served as board President. Bowyer has also volunteered on the Magic Valley Arts Council Board as well as the Twin Falls Community Foundation Board.

Bowyer received the Twin Falls Chamber of Commerce Lifetime Achievement Award, the Blue Lake Rotary Club Community Service Award, and the Rotarian’s Paul Harris Award.

CSI Athletics is still in his blood as Bowyer can be seen at all the home CSI Basketball games working on the scorer’s table and sometimes even rolling the ball cart back and forth for the teams.

“Perfection is not attainable, but if we chase perfection we can catch excellence.”
Vince Lombardi

Community Donors

Your donations make a significant difference. When you donate, you not only support our students financially, but also change the future for those students' families and communities. The generous donations acknowledged in this report were made between July 1, 2024 and June 30, 2025.

Reylene Abbott
Dale and Sheila Adams
Elizabeth Adams
Heidi A. Adams
Rosette Alberdi
Mark and Larisa Alexander
Erika Allen
Larry and Karon Amen
Chris and Crystal Anderson
Jon and Susan Anderson
Leonard and Alice Anderson
Michael and Carolyn Aoi
Teresa Archie
Terynn Archuleta
Roy and Betty Armstrong
Brian and Crystal Ayers
Marsha Azorsky
Gary and Ann Babbel
Shawn Bagley
Ryan Banasky
Eileen J. Banholzer
Marianne Barker
Scott Barker
Steve and Amy Bartholomew
Gail Bateman
Gary and Maria Baum
Nick and Karen Baumert
Catalina Bautista
David Becker II
Amber Beckstead
Ruby Behm
Maxine Bell
John and Tracy Bideganeta
Mary Bird
Susan Blair
R. Todd Blass
Robert and Norma Blass
Arlen Blaylock
Patrice Bonadiman-Bollar
Sadie Boren
Tonja Bowcut
Melody Bowyer
Carol Boyd
Chris and Lanie Bragg
Gary and Barbara Bratt
Jeff and Luann Broadhead
Gayle Brown
Shane Brown

Paula Brown Sinclair and Jim Ricks
Bill and Angie Brulotte
Rosanne Buehler
Don and Claudeen Buettner
Jeffrey Burks
Rodney K. Burks
Norman and Janet Cantor
Jerry and Carol Carlile
Marcus Carpenter
Holly M. Chappell
Catrina C. Chapple
Kyla Christenson
Connie Christiansen
Todd Christiansen
Mary Jo Church
Jeff and Kathy Cilek
Jerry and Cheri Cilek
Jeff Clausen
Tyler Clifford
Adam Cline
Lance and DeeDee Clow
Doran Cluer
Keith and Deborah Coates
Larry and Julie Coffman
Carolyn Coleman
John R. Coleman
Cydney Conger
Ron and Carol Conklin
Mandi Cornelison
Charles and Lynn Correll
Thomas and Mary Courtney
Barrett and Rachel Craig
Bryan Craig and Autumn Barney
Joyce Craig
JuLee Craig
Michelle Critchfield
Tyler Crockett
Adam Crofts
Samra Culum
Heston Curtis
Spencer and Nicke Cutler
Nikki Daisher
Ginger Dattilo
Gerardo Munoz and Rosa Davila
Shawn and Jeanna Davis
Arnold DeCastro
David Dickerson
Joshua and Cindy Dickson

Ed and Tami Ditlefsen
Brian and Kate Dobbs
Lori Donaldson
John Donnelly
Clark and Keri Draney
Carroll J. Drown
Kathryn Duncan
Kevin and Ansina Durham
Allen and Teresa Easterling
Curtis and Mardo Eaton
Bill and Ann Ebener
Branden Edwards
Mel and Joan Edwards
LueLinda Egbert
Julie Egner
Brock Ellerman
Frank and Jeanene Ellis
Laura Erickson
Jasper Eshelman
Jesse Eshelman
Estate of Bonnie Smazal
Robert and Teri Fattig
Jaysa Fillmore
Brandon and Kathrine Fiscus
Rick Fisher
Frederick and Marie Fitts, Jr.
Cindy Flowers
Marjory Fluegel
Britney Ford
Allan and Fran Frost
Michael Furniss
Perri L. Gardner
Spencer Geist
James and Barbara Gentry
Robert and Barbara Gietzen
Mary Ann Gilmore
Breck and Desiree Glassinger
Philip and Nancy Gossi
Theodore and Patricia Hadley
Donald and Jennifer Hall
Ben and Janna Hamlett
Valdon B. Hancock
Carl Haney
Brad Hanks
Jeff and Cindy Harmon
Bev Harper
Jeffrey and Susan Harris
Kenneth and Sarah Harris

Linda Wright Hartgen
Richard and Sharon Hayes
Stephen Hayward
Judy Heatwole
Joey and Brandie Heck
Howard and Antonia Hedrick
Chris Hengel
Jesse and Peggy Hess
Manda Hicks
Rodney Higgins
Mike and Magan Hodge
Barbara Hoggatt
Veronica E Hoggatt
Paula Hollifield
Gary and Linda Hollinger
Anatoliy Honcharenko
Alan and Lorinda Horner
Ray Houston
Charles and Jill Howell
Leonard and Sylvia Huber
Anita Hudson
Gary and Polly Hulsey
Joseph Intagliata
Randy and Eeva Jackson
Richard and Marilyn Jacobson
Megan Jacobson
Dick and Cindy Jardine
Melissa Jarvis
Gary and Annette Jenkins
Gordon and Jackie Jenkins
Tracy and Serena Jenkins Clark
Gary Jenks
Justin Jensen
Angela Jewell
Amy Jimenez
Harold and Vanda Johnson
Sharon R Johnston
Dianne Jolovich
Paul Jones
Ryan J. Jund
Nancy Ann Keane
Gail G. Kearns
Robert and Janet Keegan
John and Nancy Kelker
James Kellis
Michael Kelsey
Richard and Brenda Kendall
Jayme Ketterling

Community Donors

Nathaniel Jerke and
Melissa J. Kippes
Karl and Sally Kleinkopf
Payten Kleinkopf
Robert and Tina Koch
Phyllis Kochert
Marilyn Kofford
Elizabeth Kowalski
Dan and Lara Kowalski
Robert and Nancy Kunau
Darren J. Kyle
William and Donna Kyle
Eileen Lanting
Greg Lanting
Mike LaPray
Judi Laughlin
Janet Leeds
Gaea A. Lete
Desiree Libby
Ryan Lickley
Susan R. Lidstone
Lyntessa Limas
Scott and Cheryl Lindquist
Carroll and Judy Livingston, Jr.
Robert and Janet Lobb
Kendra Lockwood
Jonathan and Sarah Lord
Sam and Fran Lowman
Aaron Mabey
Heather Mack
Stacie Mackay
Daniel MacLerran
Brett Madron
Kimberly N. Madsen Dill and
Mr. Randall Dill
Matt and Kara Mahannah
Tommy Martz
Mr. Mike Mason and
Mrs. Joy Barinaga
Bryan Matsuoka
Robert A. Mayer
Scott McClure
Kara McCurdy
Shelley McEuen
Jessica McFadden
Sally A. McHargue
David and Lee McKinlay
Anne McMurry

Phyllis A. Melnyk
Denna Methmann
Chris and Tracey Meyerhoeffer
Gerald Meyerhoeffer
Jason and Michele Meyerhoeffer
Keri Mikkelsen
Lindsey Miller
Mandi Miller
Nancy Miller
Estate Of Rhonda K. Miracle
Jan M Mogensen
Katherine Molt
Macey Moore
Ryan and Deborah Moore
Steve Muth
Tammie Neff
Peter and Barbara Newton
Bruce and Ginger Nukaya
Carrie Nutsch
Pam O'Dell
Kelsey O'Leary
Karen Olen
Dawn Otero
Danielle Owen
Shirley Owen
Gary Palmer
Lana Parker
Rick and Marilyn Parker
Robert Parkinson
Terry Patterson
Tamara Pehrson
Charles and Marilyn Perkins
Steven and Joni Peterson
Donald and Bonnie Pica
Tim Pierce
Edward Gene Porath
Janet Pretti
Steve and Toni Price
Nick and Sharon Purdy
John and Linda Sue Quinn
Nina Ramsey
Susan Ramseyer
Colin and Karen Randolph
Jeff and Trish Reinert
Sarah Renaldi
Renee Resendez
Matt Reynolds
Alexand Amy Rice Doetsch

Nancy Ridgeway
Dale L. Riedesel
Wayne Riley
Mike and Cally Roach
Lawrence & Carolyn Robertson
Evan and Roberta Robertson
Zach Robinson
Scott and Erica Rogers
Jennifer Roggenkamp
Jeffrey and Kaylynne Rolig
Jeanne Rose
Linda K. Rowe
Edward and Janet Sandy
Terry and Brenda Sanford
Wayne and Alice Schenk
Chris and Anna Scholes
Scott and Kimberly Scholes
Bill and Jennie Schow
Sandy S. Scott
Tiffany Seeley-Case and
Desland Case
G. Matthew Shafer
Perry and Krista Shank
Randy Simonson
Janice Simpkin
Bruce and Debra Skaug
Shelly Skaug
Michael and Michelle Slagel
Steven and Betty Slifer
Shelby Smith
Robert and Whitney Schuler
Russell Snow
Stephen and Debbie Soran
Ray and Tia Standlee
Graydon and Tammi Stanley
Monze Stark
Laird and Vickie Stone
Paul and Kathy Stover, Jr.
Douglas and Nancy Strand
Rosemary Stroebel
Judy Studebaker
Mark and Elizabeth Sugden
Karyl Suiter
Robyn Swainston
Buffie Taylor
Jaime Tigue
Estate Of John M. Tinker
TC and Lois Tomlinson

Kevin and Linda Trainor
Jody Tremblay
Joan Turek
Carolyn Turner
Revis and Emmy Turner
Linda Uzureau
RD and Karrie Van Noy
Maritza Vega
Rita Vernon
Steven and Krista Vining
Krystal Wageman
Brenda Walker
Justin Walker
Logan Wall
Katie Wallace
Sandra K. Wapinski
Deskin and Susan Waters
Charlotte Watson
Marie Webb
Cheri Werbeck
Jesse White
Joanna White
Brien Wieser
Courtney Wilkins
Bill and Carolyn Williams
Robert and Susan Williams
Daniel and Sonja Willie
Jamin and Leslie Wills
Shawn and Erika Willsey
David and Heather Wilson
James and Cynthia Wilson
Terry and Judi Winkle
M D. Wolf
Richard Wolf
Matilda Wolfe
Georgina Wolverton
Richard and Rebecca Worst
Scott and Amy Worthington
Joseph Wrenfrow
Julie Wright-Leggett
Lori Young
Mike and Judy Youngman
George Zelenski

College of Southern Idaho Foundation Awards \$24,000 in Mini-Grants for 2025–2026 Academic Year

The College of Southern Idaho (CSI) Foundation is proud to announce the recipients of the 2025–2026 Mini-Grant Program, awarding a total of \$24,000 in funding to support innovative projects and initiatives that enhance student access, success, and community engagement.

The CSI Foundation Scholarships and Grants Committee carefully reviewed numerous proposals and selected 14 impactful projects across various departments. These grants empower faculty and staff to launch or expand initiatives that directly benefit students, academic programs, and engage the community.

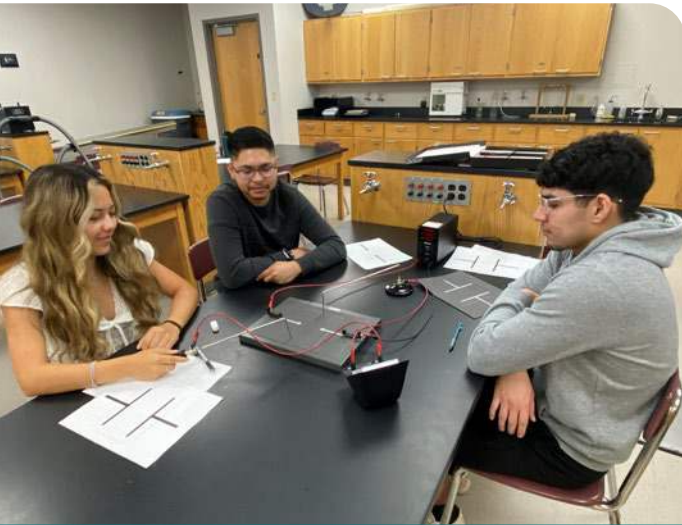

These mini grants represent the CSI Foundation's commitment to academic excellence, innovation, and community engagement. "We are incredibly proud to support projects that inspire learning, expand access, and build stronger connections between CSI and our community," said Erika Allen, Executive Director of the CSI Foundation.

- **Jennifer Hall – \$2,975 | College and Career Readiness**
Funding for supplies and testing resources for students in the Integrated CNA course.
- **Adam Valentiner – \$1,585 | Digital Media**
Purchase of outdoor and mobile strobe photography equipment.
- **Jayme Peck – \$500 | Workforce – Phlebotomy Program**
Support for a community event featuring supervised blood draws.
- **Jaime Tigue – \$500 | Mental Health Summit**
Funding for the annual Mental Health Summit and comfort box initiative.
- **Maritza Vega – \$3,000 | Welcome Center/Office of Admissions**
Renovation of the Welcome Center front area to increase accessibility.
- **Aarianna Harmon – \$500 | Herrett Center**
Sponsorships for low-income students to attend the Science Camp-In.
- **Reed Hepler – \$3,000 | Library, CSI Archives**
Digitization of historical documents related to the college and surrounding community.
- **Amy Christopherson – \$500 | Mini-Cassia Center**
Support for the Family STEM Night at the Mini-Cassia Center.
- **Ashley Lopez – \$3,000 | Surgical Technology**
Creation of a Disaster Day training event for students in healthcare programs.
- **Ben Lustig – \$1,500 | Photography Program**
Upgrades to film and digital photography equipment.
- **Dara Rodemack – \$3,000 | Business Management Program**
Purchase of a 3D scanner to support curriculum development.
- **Jaysa Fillmore – \$500 | Agriculture Department**
Creation of industry support gifts using CSI Farm resources.
- **Kara Mahannah – \$500 | Medical Assisting Program**
Support for a marketing event celebrating the program's 35th year of accreditation.
- **Mark Daily – \$2,940 | Physical Science**
Acquisition of DC power supplies for enhanced physics instruction.

Make a Donation, Make a Difference

Make a Donation



Knowledge is power. Education allows individuals to develop important life skills, find better-paying jobs, and eventually give back to their local communities. Financial struggles often remain the biggest barrier blocking Idahoans from pursuing higher education.

Without access to additional resources, higher education will remain inaccessible for students in Idaho. At the College of Southern Idaho Foundation, there are two types of scholarships

Endowed Scholarship

When you create an endowment fund, you're creating perpetual financial support for the scholarships or programs of your choosing. An endowment may be named in honor of a loved one or to create a family legacy. An endowed scholarship requires a minimum of \$10,000 to establish. Scholarships are then awarded based upon 5% of the 3-year moving average of the market value as of December 31 of each year.

Annual Scholarship

Any amount of donation can be made to pre-existing funds and/or program(s) of your choice. Gifts to CSI's Greatest Needs Fund support the College's strategic initiatives and strengthen our ability to respond to community needs and opportunities.



*Learn About
Endowments*

Metallica Scholars Fuel the Next Generation of Skilled Trades

Breaking barriers to education with funding for tools, training, and real-world experience.



College of Southern Idaho is proud to announce its selection as one of 15 nationwide recipients to join Year 7 of the prestigious Metallica Scholars Initiative (MSI). Supported by a generous \$75,000 grant aimed at enhancing support for students enrolled in high-demand trade programs including agribusiness, animal science, aquaculture, agricultural diesel, and diesel mechanics. Funds will directly aid students by covering course fees, textbooks, tools and personal protective equipment (PPE), travel for internships, industry experiences, and job training. The initiative complements CSI's broader strategy to grow enrollment in programs that meet urgent labor market demand across southern Idaho.

"This grant funding comes at a critical time," said Dean Fisher, CSI President. "As CSI continues to build capacity and align programs with regional workforce needs, this investment allows us to remove barriers for students pursuing careers in fields that are essential to Idaho's economy."

CSI thanks Metallica, the All Within My Hands Foundation, AACC, and its industry partners for recognizing the importance of investing in the skilled workforce of tomorrow.

All Within My Hands (AWMH), the non-profit, philanthropic organization created by the members and management of Metallica, recently announced its Year 7 of its Metallica Scholars Initiative (MSI) with its largest grant to date, totaling approximately \$3M. MSI now has a presence in 75 colleges across all 50 United States and the territory of Guam, and is expected to reach approximately 10,000 students.

"I could not be any prouder of our Metallica Scholars. We know that our country needs millions of skilled tradespeople, and it warms my heart to know that our Foundation's efforts are making a positive impact and putting hard-working people on the path to careers in the trades. Whether it's a school visit or a meet and greet before a show, there is no better feeling than meeting our Metallica Scholars in person and hearing their stories of grit and determination firsthand, along with their pride and commitment. It is truly inspiring. To think we started with a few schools and a couple hundred students, and we're now in 75 schools nationwide, about to reach 10,000 students. It's just incredible."

Robert Trujillo, Metallica Band Member



Launched in 2019 by All Within My Hands in partnership with the American Association of Community Colleges (AACC), MSI began with 10 colleges focused primarily on Manufacturing programs. The workforce initiative has since expanded to offer opportunities in diverse fields for students interested in gaining the skills and training necessary to establish meaningful careers that provide family-sustaining wages.

To evaluate the program's efficacy, the University of Southern California (USC) Sol Price School of Public Policy independently researched and quantified MSI's impact on the skilled trades and the return on investment (ROI) earlier this year. The research extended into all Year 6 community colleges, covering more than 350 fields of study at these institutions, measuring the cost of completion and anticipated salaries post-graduation. The key observation is that the ROI – the ratio of a program's cost to anticipated median wage – across all MSI-supported programs is a very high and cost-efficient 8.3X. This means that on average, MSI graduates can expect to earn 8.3X the upfront cost of their program during their first year in the workforce.

"2025 is a watershed moment for the Metallica Scholars Initiative," stated Peter Delgrosso, Executive Director, All Within My Hands. "With the addition of 15 new schools this fall and USC's independent research articulating the strength of our results, we are eager to tackle the quantifiable shortage of skilled labor our nation faces. If we extrapolate these ROI numbers over a career, it demonstrates how effective and profitable learning a trade can be for the individual, and how society as a whole also benefits from community college graduates. This insight will profoundly affect MSI going forward, impacting how people view careers in the trades, encouraging more corporate and individual sponsorship, and driving its advancement across the country. We're thrilled to incorporate these findings into this year's planning and expansion."

Year 7 also marks the renewal of AWMH's partnership with the Lowe's Foundation, which has provided \$1 million in support as part of its five-year, \$50 million commitment to prepare 50,000 people for skilled trades careers.

It takes a village to achieve these results, including the continued support from many long-time corporate partners of AWMH, notably workwear manufacturers Carhartt, Wolverine, and CNH, a global leader in agricultural and construction equipment. The aforementioned along with the extended Metallica Family of fans have staunchly supported AWMH from day one and worked tirelessly to advance its mission. 🙏

LeRoy Craig Jerome Center

The LeRoy Craig Jerome Center is the future of the College of Southern Idaho and we need your help. Don't pass up this unique opportunity to be an integral part of the College of Southern Idaho. Leave your lasting legacy by funding one of the following opportunities in your name or that of someone special with a gift payable over four years. For more information about this campaign email foundation@csi.edu.

Naming Opportunity		Cost
1	Conference Room	FUNDED
2	Testing	\$40,000
3	Student Lounge	\$65,000
4	Meeting Room	\$135,000
5	General Classroom	\$90,000
6	General Classroom	FUNDED
7	General Classroom	FUNDED
8	ABE Classroom	\$90,000
9	Health Occupations Classroom / Lab	\$120,000
10	Science Classroom / Lab	\$200,000
11	Science Classroom / Lab	\$200,000
12	Industrial Training Lab	\$275,000
13	Food Processing & Meat Cutting	FUNDED
14	Exterior Patio	\$150,000

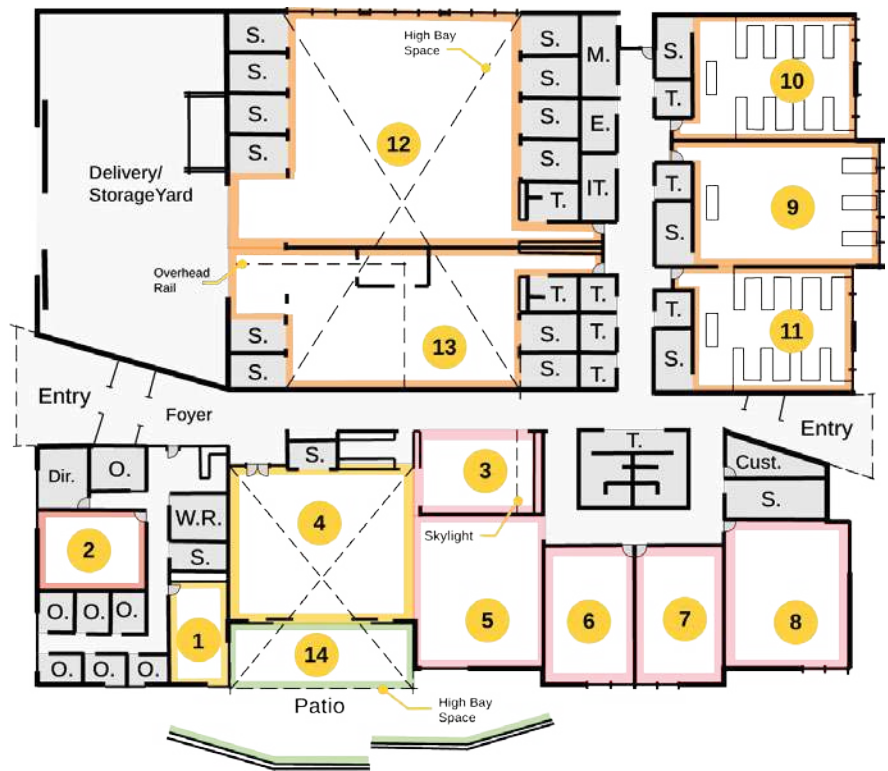

Key

- Classroom / Student area
- Outside
- Admin
- Classroom / Lab
- Testing Center
- Not for Purchase
- # Available for Purchase
- O. – Office
- S. – Storage
- T. – Toilet / Bathroom

Delta Dental of Idaho Grant

College of Southern Idaho Foundation Awarded Delta Dental Grant to Strengthen Oral Health Workforce and Expand Access to Preventive Care



The College of Southern Idaho (CSI) Foundation is proud to announce it has been awarded a grant from Delta Dental to support the expansion of CSI's dental workforce training programs and increase access to affordable oral health care in South Central Idaho.

The grant will provide funding for three key initiatives:

- **Expanding Access to Preventive Care**

Subsidizing dental clinic fees for low-income, uninsured, and underserved patients, ensuring critical services such as cleanings, screenings, and fluoride treatments remain accessible.

- **Workforce Development**

Updating and modernizing CSI's self-study online Dental Assisting program, offered through the CSI Workforce Training Center, to better serve current and future dental professionals across the state.

- **Enhanced Training and Patient Care**

Purchasing a new intraoral scanner to improve both clinical education for CSI Dental Assisting and Dental Hygiene students and the quality of care provided to patients at CSI's community dental clinic.



"Every year, CSI's dental programs not only prepare students to join Idaho's growing oral health workforce but also provide affordable, high-quality care to nearly hundreds of patients in our community," said Erika Allen, Executive Director. "This generous support from Delta Dental helps us remove barriers to care while equipping students with the training and technology they need to make an immediate impact."

South Central Idaho faces significant challenges in accessing affordable dental care, particularly for low-income families, seniors, and rural residents. With nearly 12% of the population living below the poverty line and a shortage of dental professionals statewide, the grant will help CSI address both patient needs and workforce gaps simultaneously.

"Delta Dental is committed to advancing oral health through education, prevention, and community partnerships," said Heather Brown, Senior Director, Oral Health and Community Outreach. "We are proud to support the College of Southern Idaho's efforts to expand access to care and build the next generation of oral health professionals."

The CSI Foundation extends its gratitude to Delta Dental for its investment in education, prevention, and community health.

FREE Preventative Dental Services

Thanks to a generous grant from Delta Dental of Idaho, CSI Dental Hygiene students are offering free preventative services to:

- CSI Students
- Faculty & Staff
- Community Members in Need

Contact: Nicole Popoca, Clinic Manager
208-732-6751 | dentalclinic@csi.edu



Gilbert's Interview Closet

Have you heard about Gilbert's Interview Closet? This newly developed resource, being offered by the Work-Based Learning Center, collects gently used professional clothing to help students prepare for job interviews, career fairs, internships, and their first jobs. Many students face financial barriers that make acquiring professional attire a challenge-and your donation to Gilbert's Interview Closet can make a real difference!

What to Donate:

Items must be clean, gently used, and ready to wear

- Blazers
- Professional Jackets
- Dress Shirts (Blouses & Button-Down Shirts)
- Dress Pants & Slacks
- Suits
- Ties
- Professional Shoes
- Accessories (Belts and Dress Socks)



Donations can be taken to the Applied Technology and Innovation Center (ATIC Building) Room 107. Questions about donating? Contact Work-Based Learning at 208-732-6303 or wblc@csi.edu



Letter from the Foundation President

As we stand on the threshold of a truly momentous year—the 60th anniversary of the College—we celebrate six decades of academic excellence, community impact, and transformative student experiences. This milestone is not only a tribute to our past but a bold step into the future.

I'm thrilled to share that our Foundation is nearing an extraordinary achievement of its own: approaching \$60 million in assets. This remarkable growth is a testament to the unwavering generosity of our donors, the strategic stewardship of our board and Foundation staff, and the enduring belief in the power of education to change lives.

Last year, the launch of the Idaho LAUNCH program provided vital support to countless high school graduates. Yet, the Foundation continued to see strong demand for gap funding and assistance—supporting both students and educators with financial aid and resource connections. Our commitment remains steadfast: to expand scholarships, enhance academic programs, and invest in the next generation of leaders.

As a CSI alumna and first-generation college graduate, I can personally attest to the immeasurable impact CSI has had—and continues to have—on my life. It is an absolute honor to serve as the Foundation's Board President this year and next. The generosity and commitment of our community to the success of future leaders is unlike anything I've ever witnessed.

Thank you from the bottom of my heart for your donations. Without you, the Foundation simply couldn't do what we do. 🙏

*Kathrine Fiscus, President
CSI Foundation Board*

CSI Foundation Board of Directors

Dean Fisher

CSI President

Kathrine Fiscus

Foundation President

Ty Popplewell

Board Vice President

Melody Bowyer

Board Secretary / Treasurer

Jan Mittieider

Trustee

Annie Peterson

Jim Mason

Tony Mannen

Arlen Blaylock

Brenda Hughes

Tammy Danos

John W. Wright

Silvia Rosales

Chris Seibold

Tyler Lassen

Dan Caldwell

Andrea Schaeffer

Jerry Olson

CSI Foundation Staff

Erika Allen

Judi Laughlin

Karrie Van Noy

College of
Southern Idaho
Foundation

P.O. Box 1238
Twin Falls, ID 83303-1238
ADDRESS SERVICE REQUESTED

NON PROFIT
ORGANIZATION
U.S. POSTAGE
PAID
BOISE, ID
PERMIT NO. 679



Every effort has been made to ensure accuracy in the 2024 - 2025 CSI Foundation annual report. If your name has been omitted, misspelled, or incorrectly listed, please accept our apologies and bring the error to our attention by contacting the Foundation at foundation@csi.edu or (208) 732-6395.